



Instruction Manual

P-60 / Sixty Special Poppers

Model No. 2085, 2656, 2086, 1866



Model: 2085, 2656



Model: 2086, 1866



GOLD MEDAL® PRODUCTS CO.

10700 Medallion Drive, Cincinnati, Ohio 45241-4807 USA



SAFETY PRECAUTIONS

	⚠ DANGER
	<p>Machine must be properly grounded to prevent electrical shock to personnel. Failure to do so could result in serious injury, or death. DO NOT immerse any part of this equipment in water. DO NOT use excessive water when cleaning. Keep cord and plug off the ground and away from moisture. Always unplug the equipment before cleaning or servicing. Make sure all machine switches are in the OFF position before plugging the equipment into the receptacle.</p> <p>008_051514</p>

	⚠ DANGER
	<p>Improper installation, adjustment, alteration, service, or maintenance can cause property damage, injury, or death. Any alterations to this equipment will void the warranty and may cause a dangerous condition. NEVER make alterations to this equipment. Read the Installation, Operating, and Maintenance Instructions thoroughly before installing, servicing, or operating this equipment.</p> <p>014_051514</p>

	⚠ WARNING
	<p>To avoid burns, DO NOT touch the kettle or any heated surface. DO NOT place or leave objects in contact with heated surfaces.</p> <p>013_092414</p>



	⚠ WARNING
	<p>ALWAYS wear safety glasses when servicing this equipment.</p> <p>010_010914</p>



	⚠ WARNING
	<p>No user serviceable parts inside. Refer servicing to qualified service personnel.</p> <p>011_051514</p>

	⚠ WARNING
	<p>Read and understand operator's manual and all other safety instructions before using this equipment. To order copies of the operator's manual go to gmpopcorn.com or write to Gold Medal Products Co., 10700 Medallion Drive, Cincinnati, OH 45241 USA 1-(800)-543-0862</p> <p>022_060215</p>



SAFETY PRECAUTIONS (continued)

	 WARNING
	DO NOT allow direct contact of this equipment by the public when used in food service locations. Only personnel trained and experienced in the equipment operation may operate this equipment. Carefully read all instructions before operation. 012_010914

	 WARNING
	This machine is NOT to be operated by minors. 007_010914

Note: Improvements are always being made to Gold Medal's equipment. This information may not be the latest available for your purposes. It is critical that you call Gold Medal's Technical Service Department at 1-800-543-0862 for any questions about your machine operations, replacement parts, or any service questions. (Gold Medal Products Co. does not assume any liability for injury due to careless handling and/or reckless operation of this equipment.)

INSTALLATION INSTRUCTIONS

Inspection of Shipment

After unpacking, check thoroughly for any damage which may have occurred in transit. Claims should be filed immediately with the transportation company. The warranty does not cover damage that occurs in transit, or damage caused by abuse, or consequential damage due to the operation of this machine, since it is beyond our control (reference warranty in back of manual).

Manual

Read and understand the operator's manual and all other safety instructions before using this equipment. To order copies of the operator's manual go to gmpopcorn.com or write to Gold Medal Products Co., 10700 Medallion Drive, Cincinnati, OH 45241 USA 1-(800)-543-0862.

Model Description

2085: Sixty Special 6 oz. Popper, unit has a red dome.

2656: Ultra Sixty Special 6 oz. Popper unit equipped with a PowerOff™ Control feature, heavy duty doors, and a red dome.

2086: P-60 6 oz. Popper; copper colored.

1866: P-60 6 oz. Popper unit equipped with a PowerOff™ Control feature; copper colored.

Items Included with this Unit

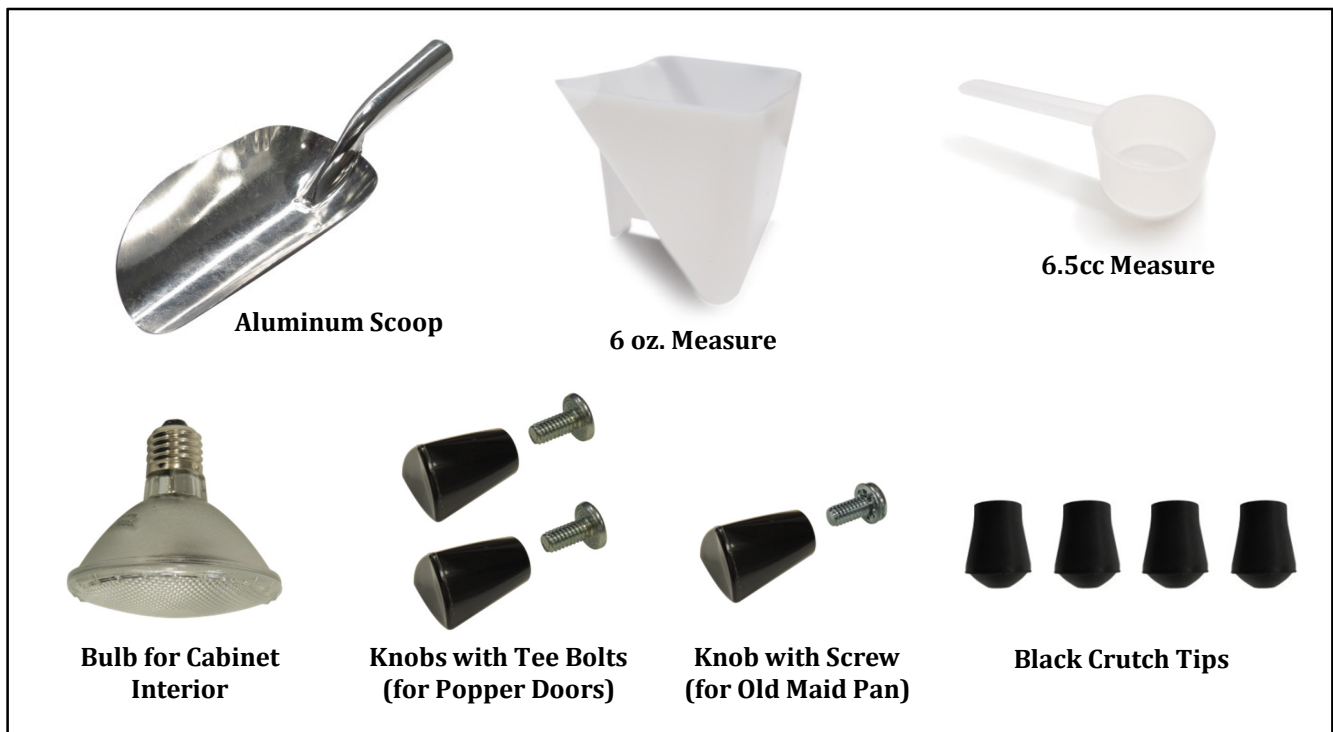

Setup

This unit has been tested at the factory.

1. Remove all packaging and tape prior to operation.
2. Place the unit on a sturdy, level base.
3. The popper unit has 4 glide feet preinstalled at the factory (see image below). Install a Rubber Crutch Tip on each of the 4 glide feet. Firmly push the crutch tip over the glide until it covers the glide entirely.
4. Door knobs are shipped in the accessories pack located inside the machine. Install a door knob with tee bolt on each popper door; install the knob with screw on the old maid pan.
5. Carefully install the light bulb (do not over-tighten) into the lamp holder located in the cabinet interior. Ensure the unit is OFF and unplugged before installing or changing the bulb (reference the Electrical Requirements section).

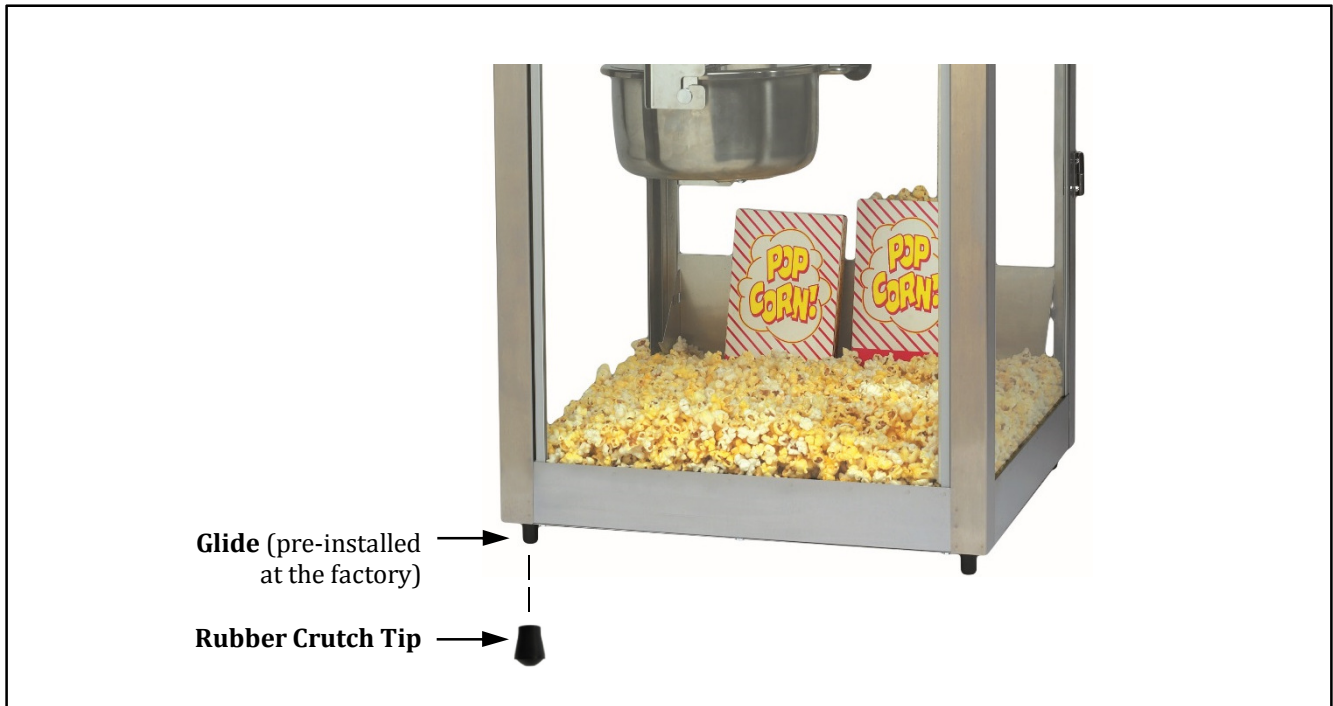





Electrical Requirements

The following power supply must be provided:



2085, 2086, 1866: 120 V~, 1220 W, 60 Hz
2656: 120 V~, 1300 W, 60 Hz

 DANGER	
	<p>Machine must be properly grounded to prevent electrical shock to personnel. Failure to do so could result in serious injury, or death. DO NOT immerse any part of this equipment in water. DO NOT use excessive water when cleaning. Keep cord and plug off the ground and away from moisture. Always unplug the equipment before cleaning or servicing. Make sure all machine switches are in the OFF position before plugging the equipment into the receptacle.</p> <p style="text-align: right; font-size: small;">008_051514</p>

Your electrician must furnish sufficient power for proper machine operation. We recommend this equipment be on a dedicated and protected circuit. Failure to wire properly will void the warranty and may result in damage to the machine. It is Gold Medal Products Co.'s recommendation that this machine be plugged directly into a wall outlet. The use of extension cords is not recommended due to safety concerns, and may cause sacrificed and/or reduced performance. Make sure cord is located to prevent a trip hazard or unit upset.

Before You Plug In Machine

1. Make sure all machine switches are in the OFF position before plugging the equipment into the receptacle.
2. Make sure the wall outlet can accept the grounded plugs (where applicable) on the power supply cord.
3. The wall outlet must have the proper polarity. If in doubt, have a competent electrician inspect the outlet and correct if necessary.
4. DO NOT use a grounded to un-grounded receptacle adapter (where applicable).
5. Install the unit in a level position.

 CAUTION	
	<p>If the supply cord is damaged, it must be replaced by Gold Medal Products Co., its service agent or similarly qualified persons in order to avoid a hazard.</p> <p style="text-align: right; font-size: small;">039_080614</p>



OPERATING INSTRUCTIONS

Controls and Their Functions

KETTLE HEAT SWITCH

Two position, ON/OFF lighted rocker switch - supplies power to the heating element in the kettle. The green switch light ON indicates there is power to the kettle heating element.

KETTLE MOTOR SWITCH

Two position, ON/OFF lighted rocker switch - supplies power to the kettle agitator motor. The Kettle Motor Switch **MUST** be ON at all times when there is popcorn (popped or un-popped) in the kettle.

LIGHTS/WARMER SWITCH

Two position, ON/OFF lighted rocker switch - supplies power to the interior cabinet light and corn pan heat element.

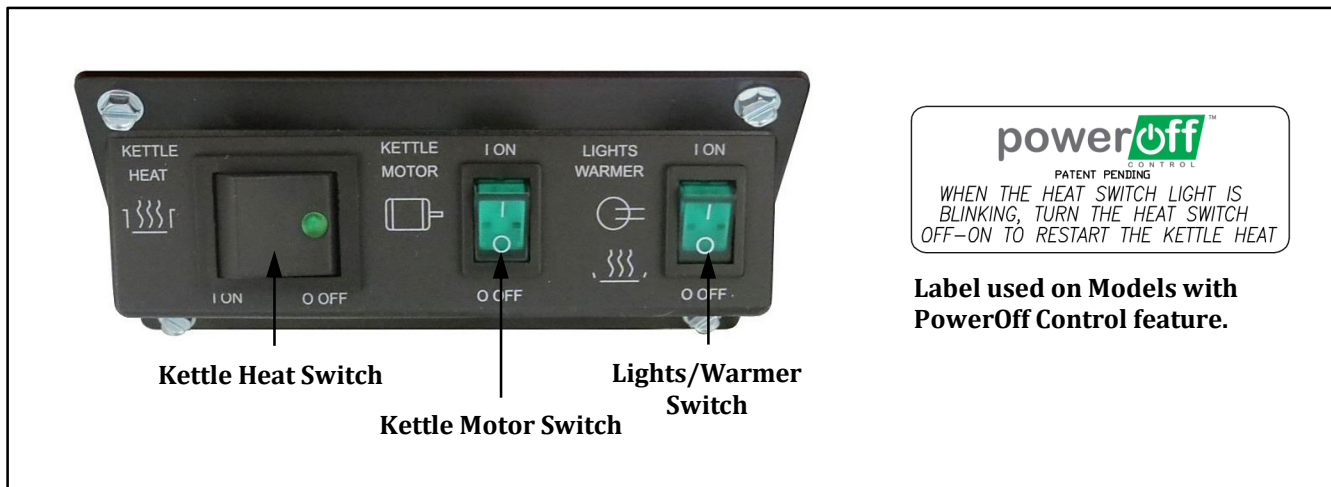

POWEROFF CONTROL (Model 2656 and 1866)

The PowerOff Control feature will automatically turn the kettle heat off after 15 minutes of idle time (no popcorn popped). The PowerOff Control will prevent the heat element and thermostat from cycling OFF-ON if the Kettle Heat Switch is left on. This feature saves electrical power and extends the life of the kettle heating element and thermostat.

1. When the Kettle Heat Switch is turned ON, and the kettle thermostat switches OFF, the PowerOff Control's 15 minute timer starts; the 15 minute timer resets each time a batch of popcorn is popped.
2. The small green neon light in the Kettle Heat Switch will blink OFF-ON to indicate the kettle has been automatically turned OFF.
3. To restart the kettle heating, cycle the Kettle Heat Switch OFF-ON.



Popping Corn

This section describes instructions for popping Standard (salted popcorn).

Amount of Popcorn and Oil

Your new popper is equipped with a corn, salt, and oil measure. We recommend flavored and colored coconut oil. Popcorn popped in coconut oil stays fresh longer and does not leave black deposits in your kettle like other oils. Use only top quality, fresh popcorn from reputable suppliers.

Ingredient amounts for popping Standard Popcorn:

Kettle Size	Popcorn Charge	Oil Charge	Flavacol (Salt)
6 oz.	6 oz. (177 ml)	2 oz. (59 ml)	1/2 Tblsp. (7.5cc)

For best results use Mega-Pop® 6 oz. premeasured pouches (Item# 2836).

Popping Standard (Salted) Popcorn

1. Turn the Lights/Warmer, Kettle Heat and Kettle Motor Switches ON.
2. To determine when the kettle is ready to pop corn (about 4 minutes), test pop three kernels of corn and one ounce (30 ml) of popping oil. When the kernels pop, the kettle is ready for use.
3. Lift the kettle lid and load the Mega-Pop® premeasured popcorn and oil pouch into kettle, or pour in the popcorn and Flavacol, then add oil in the premeasured amounts specified above. Close lid.
4. When the corn has finished popping, gently dump the popcorn.
5. On the final kettle of corn, turn the Kettle Heat Switch OFF just as the lids are forced open by the popping corn. This procedure saves electricity, since the kettle has plenty of heat, and helps eliminate smoke/odor from any oil residue that remains after popping has stopped.
6. When finished popping, make sure KETTLE HEAT and KETTLE MOTOR switches are turned OFF.

NEVER LEAVE THE HEAT ON WHEN YOU ARE NOT POPPING CORN!

Models with PowerOff Control, unit will automatically shut kettle heat OFF after 15 minutes of idle time (no popcorn popped). To restart kettle heating, cycle the Heat Switch OFF-ON.



Care and Cleaning

	 DANGER
	<p>Machine must be properly grounded to prevent electrical shock to personnel. DO NOT immerse in water. Always unplug the equipment before cleaning or servicing.</p> <p style="text-align: right;">025_020314</p>

Good sanitation practice demands that all food preparation equipment be cleaned regularly (only use non-toxic, food grade cleaners). A clean looking, well-kept machine is one of the best ways of advertising your product.

Note: It is extremely important to follow all of the cleaning procedures, otherwise parts damage and equipment failure will result. The warranty does not cover parts that are damaged due to improper cleaning.

Daily Kettle Cleaning Instructions

1. In between batches of popping corn, wipe the kettle with a clean, soft cloth. It is easy to keep the outside of the kettle clean when it is warm and the oil is not baked on.

CAUTION: The hot kettle will cause burns if you touch it with your hand. Allow kettle to cool at least 1 hour before attempting to clean.

	 WARNING
	<p>To avoid serious burns, DO NOT touch the kettle while it is hot!</p> <p style="text-align: right;">028_020314</p>

2. Every night, mix Gold Medal's Heat'n Kleen solution (Item No. 2095), 2 tablespoons per gallon of water. It is not necessary to use the entire gallon at once; only use enough to fill the kettle 1/2 inch deep.
3. Turn the kettle heat ON. When the water starts to boil, turn the kettle heat OFF.
4. Allow to cool for 30 minutes, then dump the solution into a bucket and wipe the inside of the kettle with a clean cloth. Make sure all of the solution goes into the bucket; do not spill any in the interior of the machine.

If the kettle is very dirty, this step may be repeated more than once or allow solution to work overnight. The next morning, dump the solution into a bucket and wipe the inside of the kettle with a clean cloth.

5. With the unit OFF and unplugged, wipe the kettle lead cord with a clean **SLIGHTLY** damp cloth. **DO NOT get moisture into the kettle lead-in cord, severe damage will result.**



Daily Unit Cleaning Instructions

1. With the machine OFF, unplug the unit and allow it to cool before attempting to clean.
2. Make sure to clean all pans/accessories in order to sanitize them before each use.
3. Take a clean, SLIGHTLY damp cloth and wipe excess grease from the glass and cabinet.
4. Wipe the stainless steel parts with a clean cloth and cleaner designed for stainless steel, such as Gold Medal Watchdog Stainless Cleaner (Item No. 2088).

DO NOT use oven cleaners or abrasive materials as they will damage parts of the machine.

5. Clean the glass panels with glass cleaner. Gold Medal Watchdog Glass Cleaner (Item No. 2588) is recommended.

Ammonia cleaners will damage the plastic doors. Use only non-ammonia cleaners, such as Gold Medal Watchdog Glass Cleaner (Item No. 2588).



Troubleshooting



Issue	Possible Cause	Solution
Kettle Does Not Heat	<ul style="list-style-type: none"> A. Power to Unit B. Power to the Kettle C. PowerOff Control D. Kettle Heat Switch E. Heating Element 	<ul style="list-style-type: none"> A. Make sure power cord is plugged in. B. Make sure the kettle lead-in cord is plugged in. C. Units with the PowerOff Control feature, kettle heat will automatically shut OFF after 15 minutes of idle time (no popcorn popped). To restart kettle heating, cycle the Heat Switch OFF-ON. Reference the Controls and Their Functions section of this manual. D. Have a qualified service person check the voltage to and from the Kettle Heat Switch; if switch is defective, replace it. E. Heating element in the kettle may be burned out. Check with a qualified service person for inspection/repair.
Long Popping Cycles (Longer than 4 minutes for Salt Popcorn)	<ul style="list-style-type: none"> A. Low Voltage B. Inadequate Supply Lines C. Inferior Corn 	<ul style="list-style-type: none"> A. If the machine is operated on low voltage, this could cause the kettle not to reach the proper operating temperature. Voltage with kettle turned on, should be at least 112 V. Check with a qualified electrician. The use of extension cords is not recommended due to safety concerns, and may cause sacrificed and/or reduced performance. If the use of an extension cord cannot be avoided then be sure it is no longer than 10 to 12 ft., and is at least 14 AWG wire. B. Inadequately sized electrical supply lines, in addition to being a fire hazard, would also prevent the kettle from reaching the proper operating temperature. Check with a qualified electrician. C. Inferior quality corn would result in longer popping cycles. Use only top quality hybrid popcorn from reputable suppliers. Even then, if you let your corn pick up moisture or dry out, your popping cycles will be slow.
Kettle Agitator Shaft not Rotating (continued on next page)	<ul style="list-style-type: none"> A. Kettle Motor Switch 	<ul style="list-style-type: none"> A. If the kettle agitator shaft is not rotating, DO NOT pop corn. Make sure the Kettle Motor Switch is ON. If the switch is ON, and the shaft is not rotating, the switch or motor may be faulty, contact qualified service personnel for inspection/repair.







Issue	Possible Cause	Solution
Kettle Agitator Shaft not Rotating (continued)	B. Kettle Agitator Shaft /Stir Blade	B. If the kettle agitator shaft is not rotating, DO NOT pop corn. Check the clearance between the kettle bottom and the stir blade; it should be 1/32" (use a dime). To adjust, loosen the set screw in the collars above and below the crossbar and adjust the agitator shaft as necessary. Then re-tighten the set screws in the collars.





Maintenance Instructions

	 DANGER
	<p>Machine must be properly grounded to prevent electrical shock to personnel. Failure to do so could result in serious injury, or death. DO NOT immerse any part of this equipment in water. DO NOT use excessive water when cleaning. Keep cord and plug off the ground and away from moisture. Always unplug the equipment before cleaning or servicing. Make sure all machine switches are in the OFF position before plugging the equipment into the receptacle.</p> <p>008_051514</p>

	 DANGER
	<p>Improper installation, adjustment, alteration, service, or maintenance can cause property damage, injury, or death. Any alterations to this equipment will void the warranty and may cause a dangerous condition. NEVER make alterations to this equipment. Read the Installation, Operating, and Maintenance Instructions thoroughly before installing, servicing, or operating this equipment.</p> <p>014_051514</p>

	 WARNING
	<p>No user serviceable parts inside. Refer servicing to qualified service personnel.</p> <p>011_051514</p>

	 CAUTION
	<p>THE FOLLOWING SECTIONS OF THIS MANUAL ARE INTENDED ONLY FOR QUALIFIED SERVICE PERSONNEL WHO ARE FAMILIAR WITH ELECTRICAL EQUIPMENT. THESE ARE NOT INTENDED FOR THE OPERATOR.</p> <p>027_010914</p>



ORDERING SPARE PARTS

1. Identify the needed part by checking it against the photos, illustrations, and/or parts list.
2. Use only approved replacement parts when servicing this unit.
3. When ordering, please include part number, part name, and quantity needed.
4. Please include your model number, serial number, and date of manufacture (located on the machine nameplate/data plate) with your order.
5. Address all parts orders to:

Parts Department
Gold Medal Products Co.
10700 Medallion Drive
Cincinnati, Ohio 45241-4807

Or, place orders by phone or online:

Phone: (800) 543-0862
(513) 769-7676
Fax: (800) 542-1496
(513) 769-8500
E-mail: info@gmpopcorn.com
Web Page: gmpopcorn.com



Replacing Broken Glass

Broken glass panels can be easily replaced. Gold Medal Products Co. does not ship glass. It can be obtained from a local glass shop and always purchase tempered glass.

1. Remove all loose pieces of glass (Dome must be removed to replace glass).
2. Remove all rigid glass channels from around the glass to be replaced. Set it aside as it must be reused.
3. Carefully remove the rest of the broken glass.
4. Apply decals (if desired) to the new glass panel.
5. Slide rigid glass channels over the exposed sides and bottom of new glass panel.
6. Carefully lower new glass panel into machine.
7. Reinstall Dome.

GLASS DIMENSIONS (Height X Width X Thickness)

Front Glass: 22 3/8" X 16 15/16" X 1/8" (1 Piece)

Side Glass: 22 3/8" X 14 15/16" X 1/8" (2 Pieces)

6 oz. Kettle Assembly – 56000 – Parts Breakdown

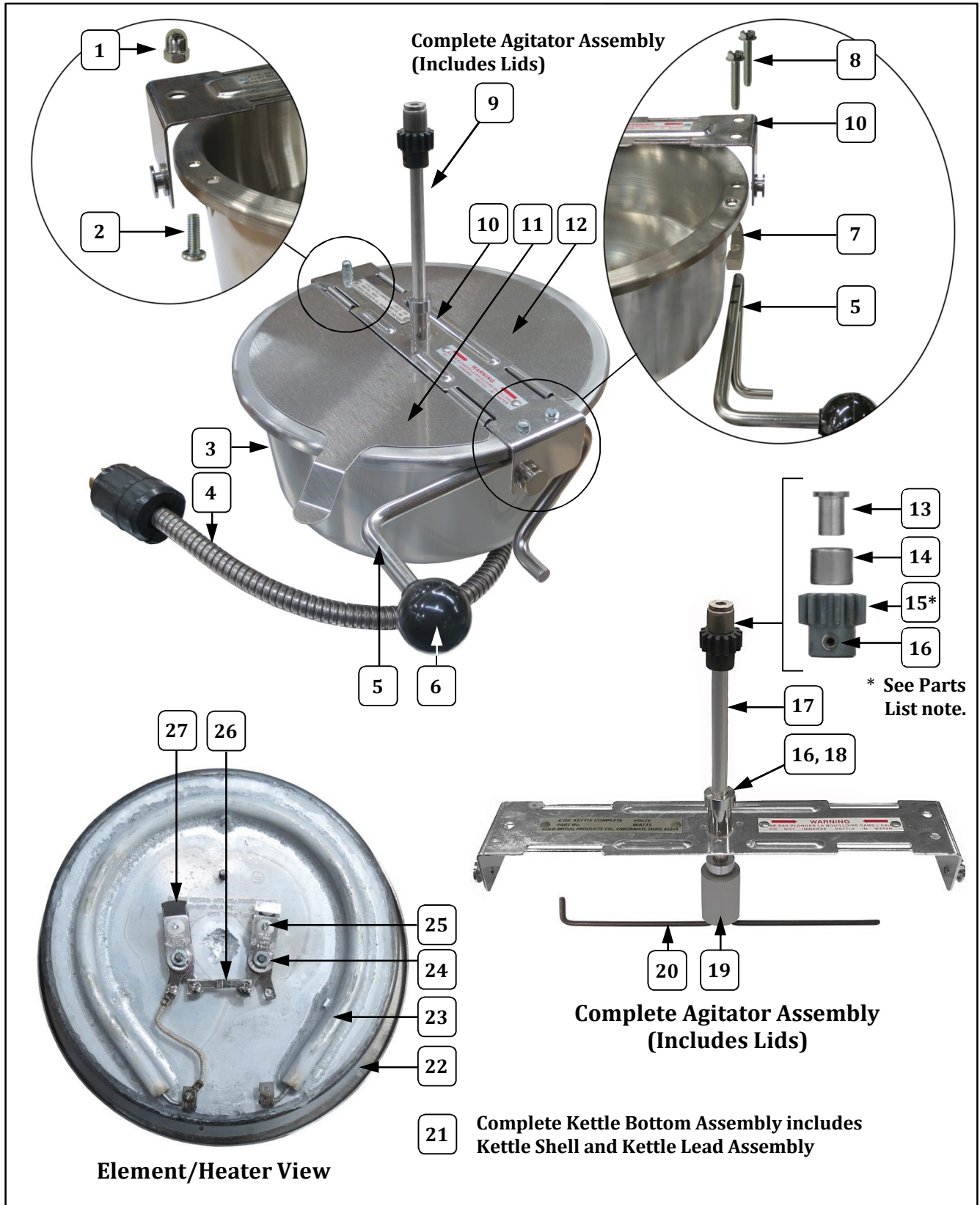



6 oz. Kettle Assembly – 56000 Parts List

Item	Part Description	Part No.
		56000
1	ACORN NUT	47702
2	8-32 X 1/2 PHIL PAN M/S	47141
3	6 OZ. KETTLE SHELL	49431
4	6 OZ. KETTLE LEAD ASSY	49328
5	DUMP HANDLE RH	49314
6	DUMP HANDLE KNOB	47110
7	SPACER (for Dump Handle)	49362
8	#8-32 X 1 SLOT HEX HD	38207
9	LID & AGITATOR ASSY (Complete Assembly)	59103
10	KETTLE CROSSBAR ASSEMBLY	59102
11	FRONT LID W/FORMED LIFTER	49017
12	REAR KETTLE LID	49016
13	AGITATOR BEARING HUB	43434
14	NEEDLE BEARING	47106
15*	SPUR GEAR (NOTE: Always replace Agitator Spur Gear and Kettle Drive Motor Gear as a set.)	47060
16	SET SCREW #10-32 X 3/16	41742
17	6 OZ. AGITATOR SHAFT	69710
18	SET COLLAR 5/16 ID 5/8 OD	46649
19	AGITATOR WEIGHT	69715
20	6 OZ. STIR ROD	69714
Kettle Bottom Assembly - Element/Heater View		
21	6 OZ. KETTLE BOTTOM ASSEMBLY (Complete Assembly - includes Kettle Shell, Kettle Lead Assembly and parts listed below)	56000W
22	6 OZ. KETTLE GASKET	49368
23	6 OZ. 780 WATT KETTLE/HEATER	56006
24	8-32 TOP LOCK NUT (holds Thermostat)	67943
25	450°F THERMOSTAT (includes two 6-32 X 3/16 Screws)	76089
26	THERMOSTAT SHUNT BAR	47193
27	525°F THERMOSTAT (includes two 6-32 X 3/16 Screws)	76702



Cabinet Exterior – Front View

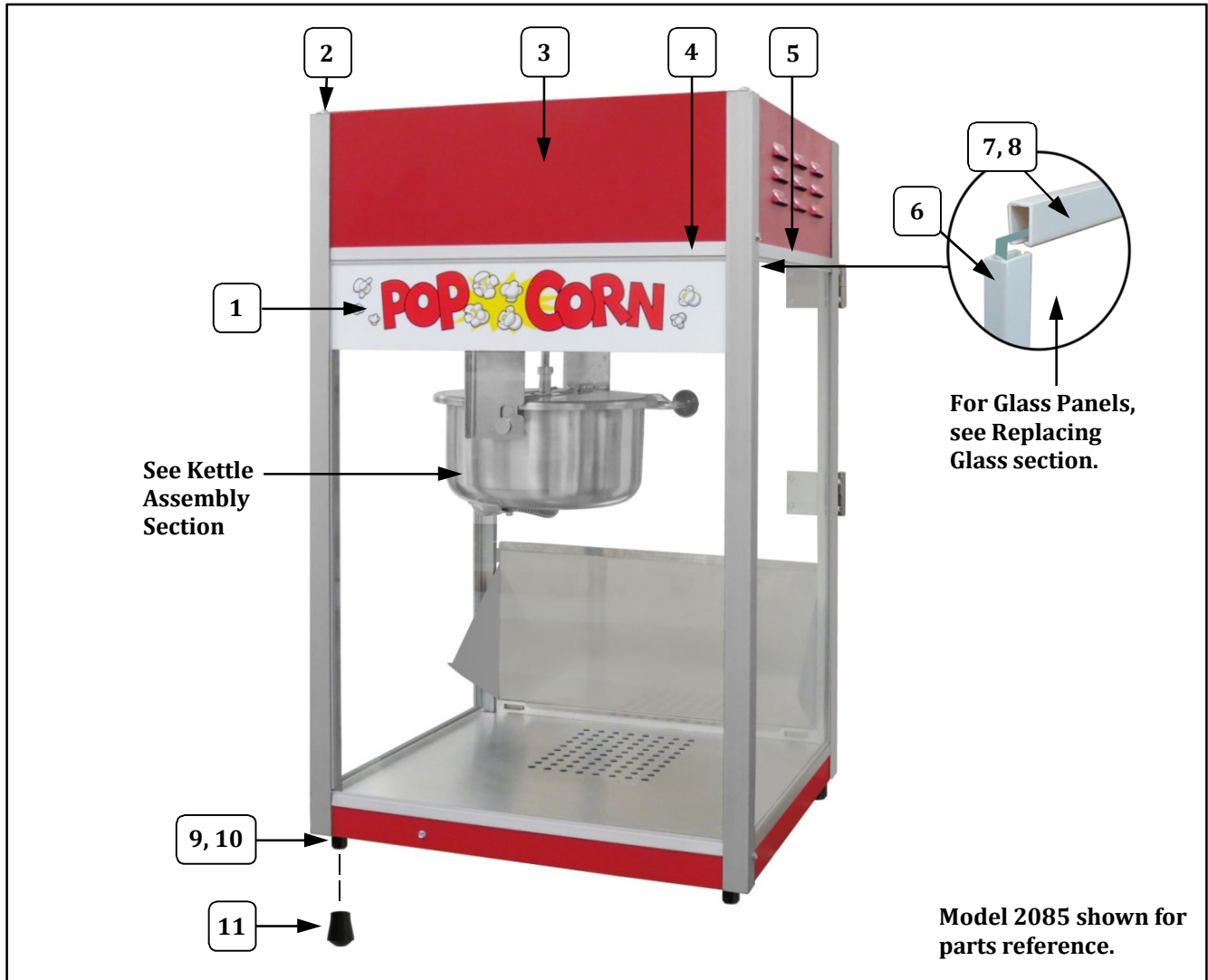

Item	Part Description	Part Number	
		2085, 2656	2086, 1866
1	FRONT GLASS DECAL	49158	77506
2	8-32" X 5/8" TYPE 23 HX HD	49052	49052
3	TOP PAN (Dome)	49452	49769
4	GLASS EXTRUSION (Front Glass)	74164	74164
5	GLASS EXTRUSION (Side glass)	49508	49508
6	21 5/8" GLASS CHANNEL (used on sides of glass panels)	49509	49509
7	15" GLASS CHANNEL (used on top and bottom of side glass panels)	49510	49510
8	17" GLASS CHANNEL (used on top and bottom of front glass panel)	49511	49511
9	GLIDE	47328	47328
10	10-24 X 3/4 HEX HD	41314	41314
11	BLACK CRUTCH TIP	49123	49123



Cabinet Exterior – Rear View

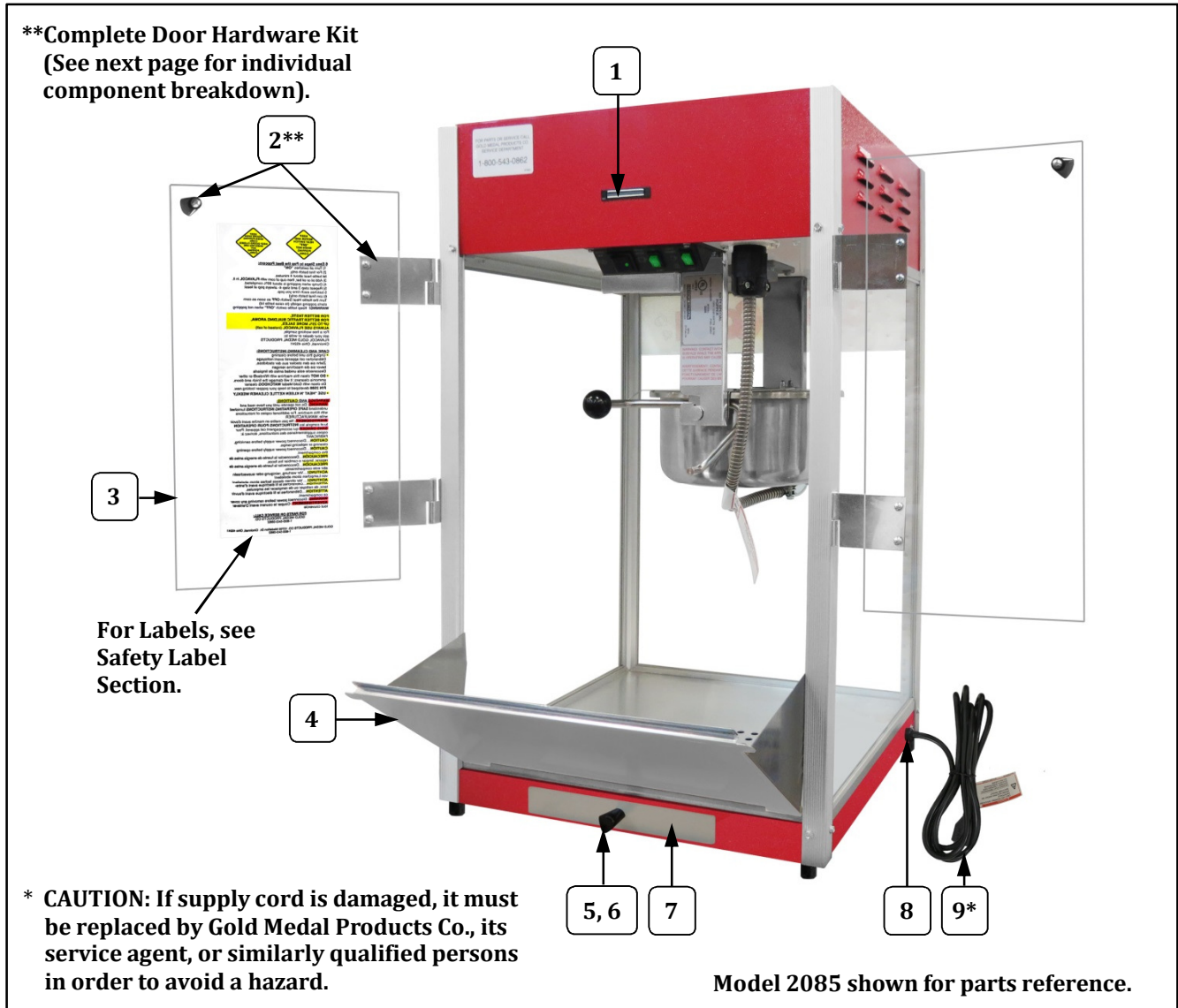

Item	Part Description	Part Number	
		2085, 2086, 1866	2656
1	MAGNETIC CATCH	47561	47561
2**	COMPLETE DOOR HARDWARE KIT	61380	61380
3	PLEXIGLASS DOOR	49395	49395HD
4	DROP PANEL	49145	49145
5	KNOB LID LIFT	47120	47120
6	8-32" X 3/8" PH PAN W/SEMS	42227	42227
7	OLD MAID PAN	49100	49100
8	#SR-6P3-4 STRAIN RELIEF	76026	76026
9*	POWER SUPPLY CORD	22038	22038



Door Hardware Kit 61380 – Individual Component Breakdown

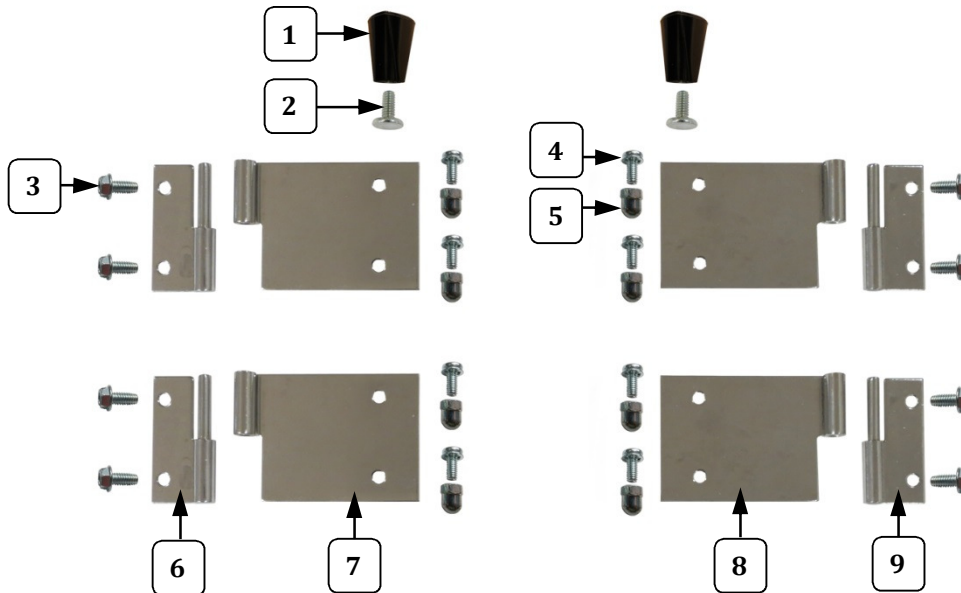

Complete Door Hardware Kit (P/N 61380)
(contains all parts shown above)

Item	Part Description	Part No.
		61380
1	KNOB LID LIFT	47120
2	TEE BOLT	75267
3	8-32 X 5/16 SLOTTED HEX	49594
4	8-32 X 3/8 PH PAN W/SEMS	42227
5	ACORN NUT #8-32	47702
6	MALE HINGE SHORT LEFT	41349
7	FEMALE HINGE LEFT HAND	61359
8	FEMALE HINGE RIGHT HAND	61373
9	MALE HINGE SHORT RIGHT	41350

Cabinet Interior – Hanger Assembly

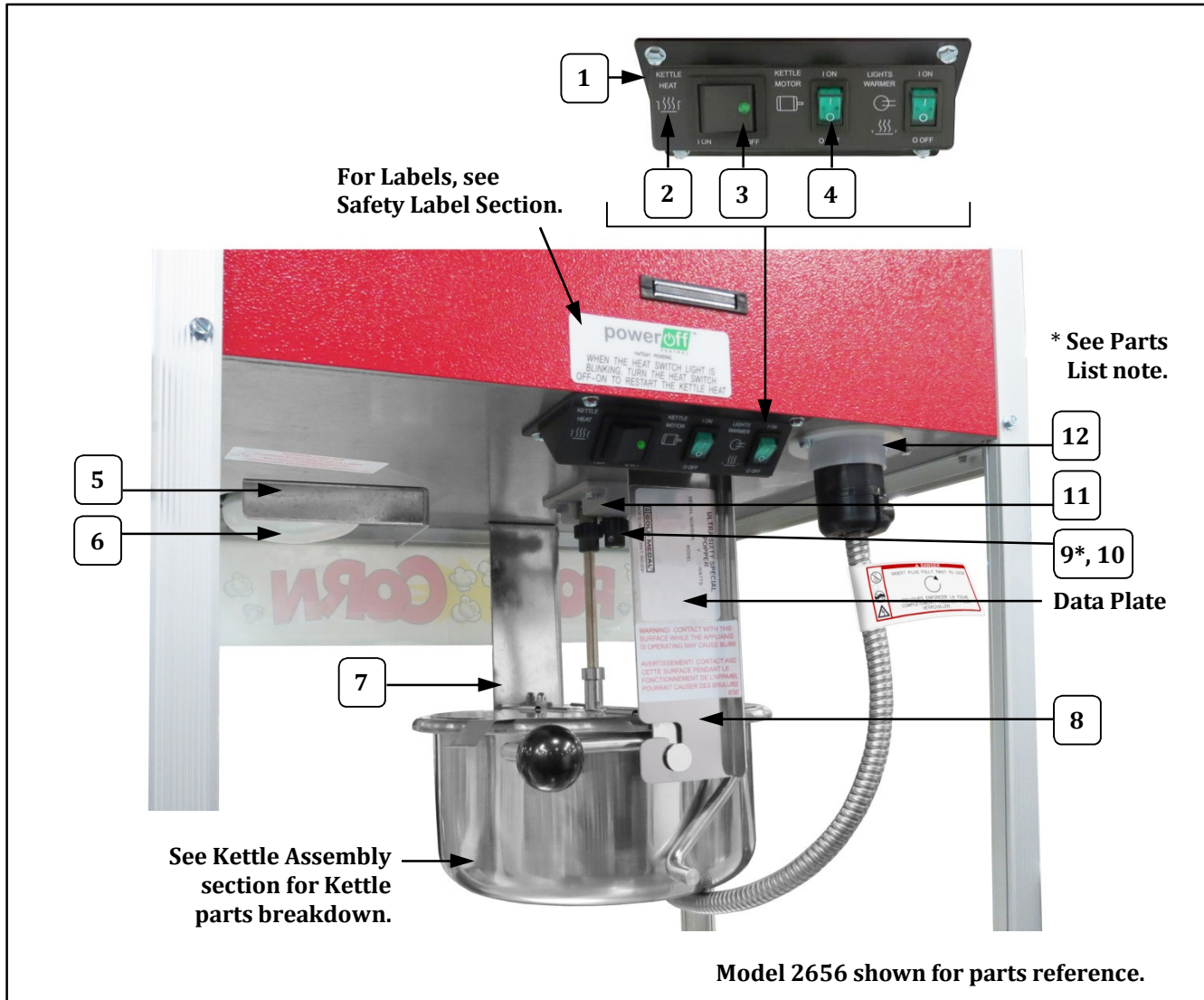

Item	Part Description	Part No.
		All Models
1	SMALL SWITCH BOX	48501
2	SWITCH BOX LABEL	48502
3	GREEN LIGHTED ROCKER SWITCH	42798
4	DPST ROCKER SWITCH	42532
5	LIGHT SHIELD ANGLE	47799
6	REFLECTOR FLOOD 65W	41671
7	REAR HANGER ARM	49009
8	FRONT HANGER ARM	49010
9	SPUR GEAR (NOTE: Always replace Agitator Spur Gear and Kettle Drive Motor Gear as a set.)	47060
10	10-32" X 3/16" SET SCREW	41742
11	GEAR BLOCK ASSEMBLY	67194A
12	15 AMP TWIST LOCK KETTLE RECPT	49330



Cabinet Interior – Bottom View

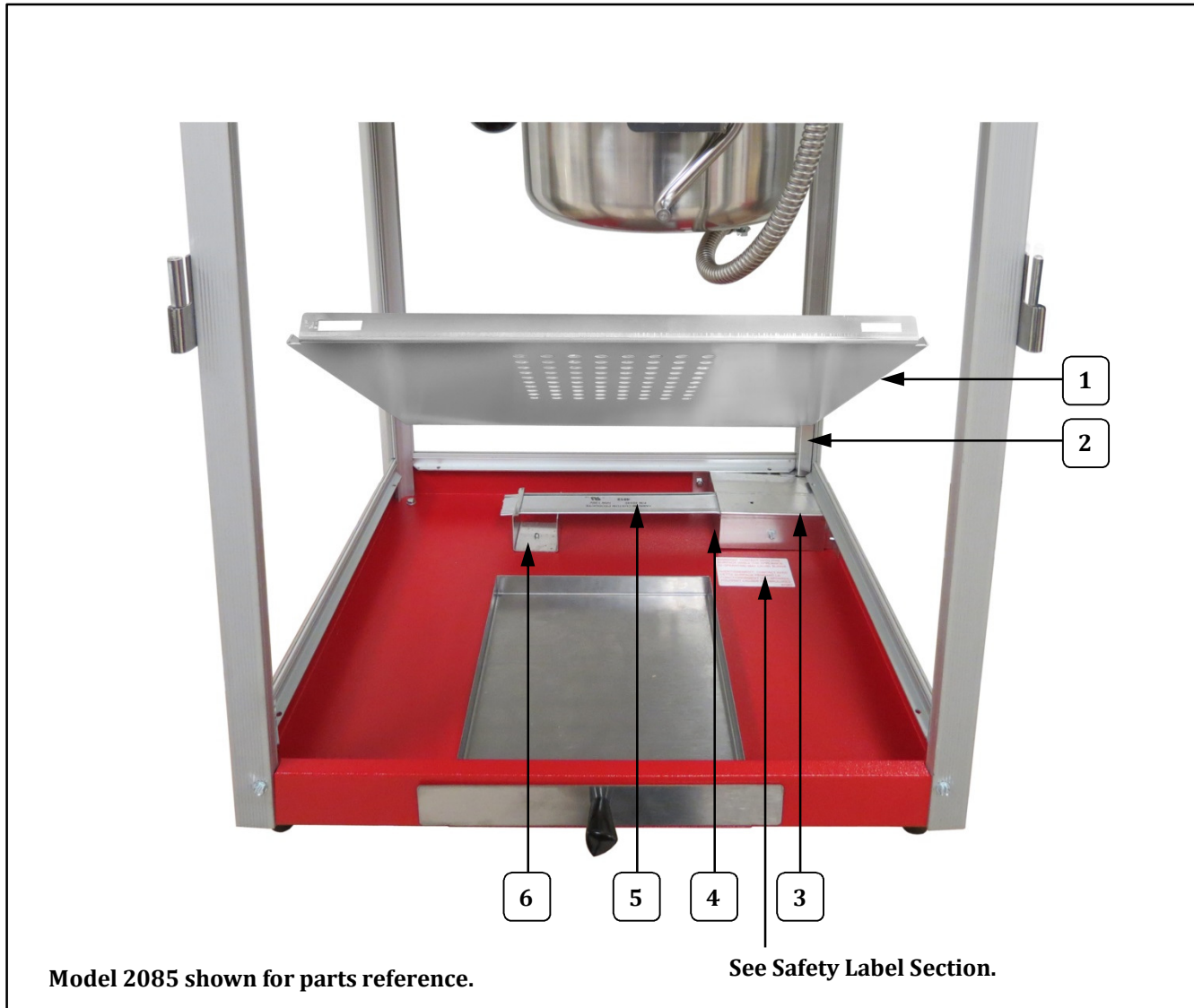

Item	Part Description	Part No.
		All Models
1	BOTTOM CORN PAN	49506
2	WIRE DUCT (Runs the entire length of the corner post)	49091
3	CORNER COVER – COVER	49104
4	CORNER COVER	49105
5	STRIP HEAT ELEMENT 50W	49440
6	STRIP HEATER BRACKET	49425

Dome Interior – Electrical Components

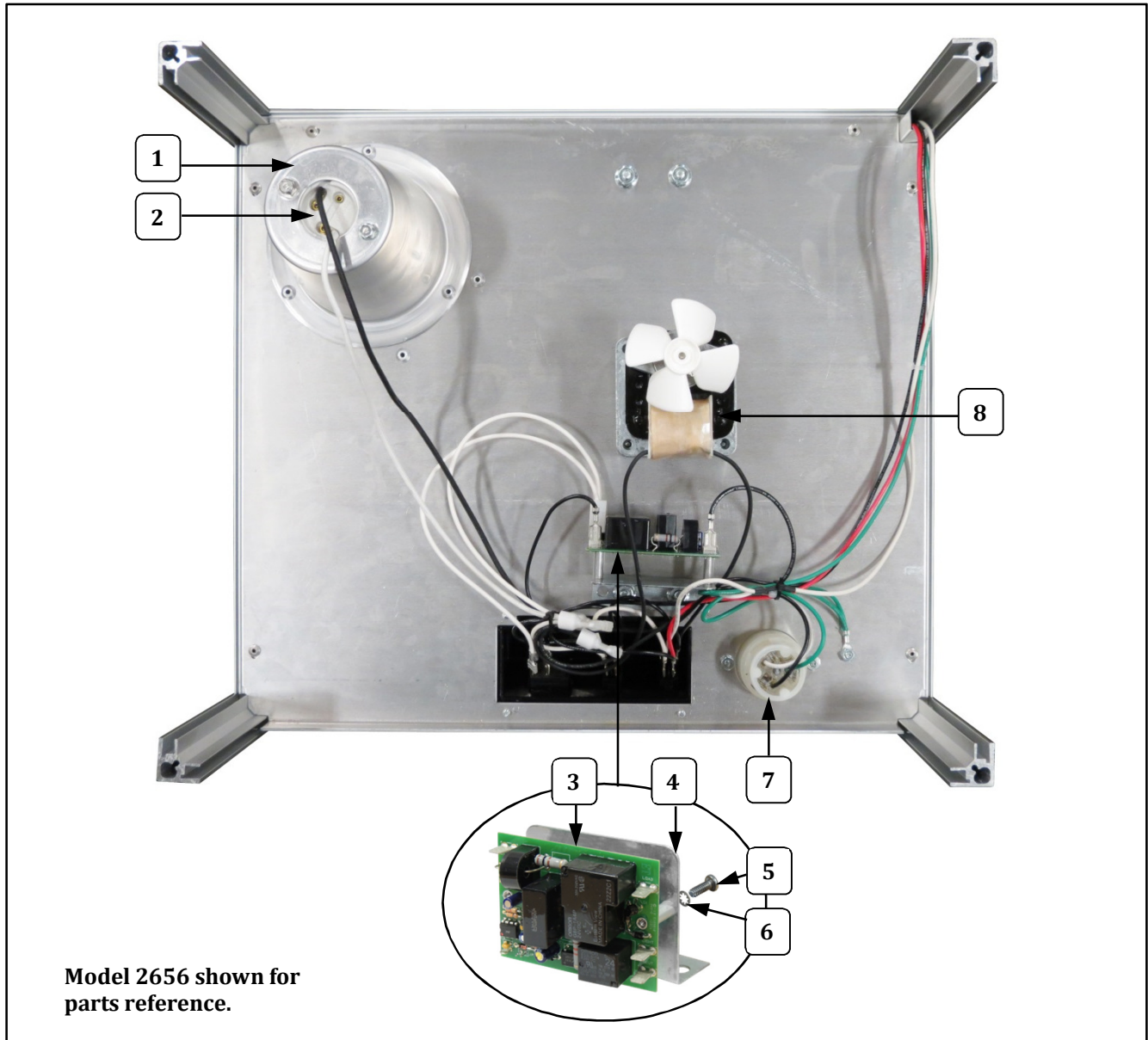

Item	Part Description	Part Number	
		2085, 2086	2656, 1866
1	SHORT LIGHT CONICAL	49480	49480
2	LAMP HOLDER	47047	47047
3	AUTO KETTLE POWEROFF CNTRL PCB		55402
4	BRACKET, KETTLE POWEROFF CNTRL		55427
5	6-32 X 3/8 PHIL PAN M/S		39000
6	#6 INTERNAL TOOTH L/W 410SS		39001
7	15 AMP TWIST LOCK KETTLE RECPT	49330	49330
8	120 VOLT KETTLE DRIVE MOTOR	47038	47038



Safety Labels

1 → **MAXIMUM LAMP SIZE**
75
PUISSANCE MAXIMALE DE LA LAMPE
WATT
MAXIMALE LAMPENLEISTUNG
CAPACIDAD MAXIMA DE LA LAMPARA 41452

2 → **UNPLUG THIS UNIT BEFORE CLEANING**
DEBRANCHER CET APPAREIL AVANT NETTOYAGE
ZIEHN SIE DEN STECKER AUS DER STECKDOSE,
BEVOR SIE DIE MASCHINE REINIGEN
DESCONECTE ESTA UNIDAD ANTES DE LIMPIARLA

3 → **FOR PARTS OR SERVICE CALL**
GOLD MEDAL PRODUCTS CO.
SERVICE DEPARTMENT
1-800-543-0862
87935

4 → **UNIVERSAL POPPER DECAL**

5 → **MAIN GROUND LABEL**
42375

6 → **WARNING! CONTACT WITH THIS SURFACE WHILE THE APPLIANCE IS OPERATING MAY CAUSE BURNS**
AVERTISSEMENT! CONTACT AVEC CETTE SURFACE PENDANT LE FONCTIONNEMENT DE L'APPAREIL POURRAIT CAUSER DES BRULURES 87087

7 → **powerOff CONTROL**
PATENT PENDING
WHEN THE HEAT SWITCH LIGHT IS BLINKING, TURN THE HEAT SWITCH OFF-ON TO RESTART THE KETTLE HEAT

On units with PowerOff Control feature only.

Unit Labels

8 → **CONDUIT WARNING LABEL**
82840

9 → **WARNING LABEL CORD**
68720

Item	Part Description	Part Number	
		2085, 2086	2656, 1866
1	WARNING, MAX LAMP 75W	41452	41452
2	LABEL UNPLUG TO CLEAN	76097	76097
3	SERVICE LABEL	87935	87935
4	UNIVERSAL POPPER DECAL	41019	41019
5	MAIN GROUND LABEL	42375	42375
6	WARNING, SURFACE CONTACT	87087	87087
7	LABEL POWEROFF CNTRL		55436
8	CONDUIT WARNING LABEL	82840	82840
9	WARNING LABEL CORD	68720	68720



Accessories

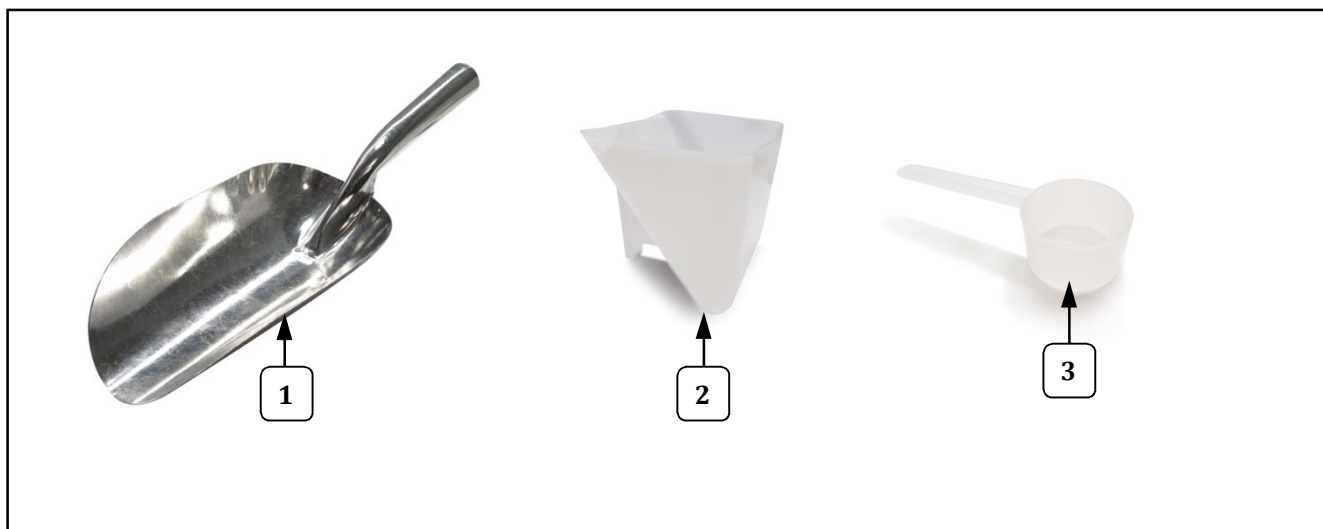

Item	Part Description	Part No.
1	STAMPED ALUMINUM SCOOP	2071
2	MEASURE 6.5 cc	47678
3	MEASURE 6 oz.	49049



Wiring Diagram

Model No. 2085, 2086

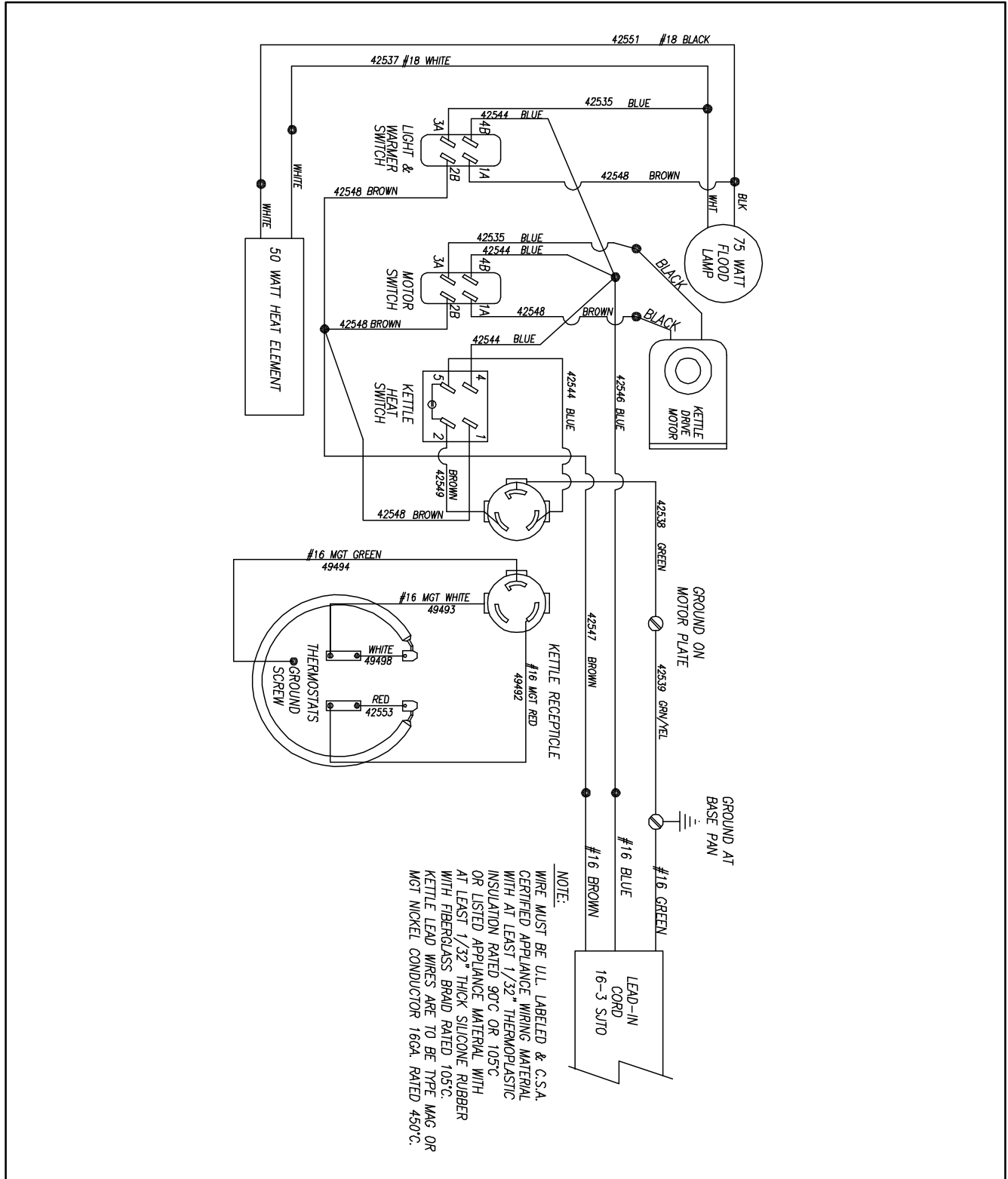

NOTE:
WIRE MUST BE U.L. LABELED & C.S.A. CERTIFIED APPLIANCE WIRING MATERIAL WITH AT LEAST 1/32" THERMOPLASTIC INSULATION RATED 90°C OR 105°C OR LISTED APPLIANCE MATERIAL WITH AT LEAST 1/32" THICK SILICONE RUBBER WITH FIBERGLASS BRAID RATED 105°C. KETTLE LEAD WIRES ARE TO BE TYPE MAG OR MGT NICKEL CONDUCTOR 16GA. RATED 450°C.



Model No. 2656, 1866

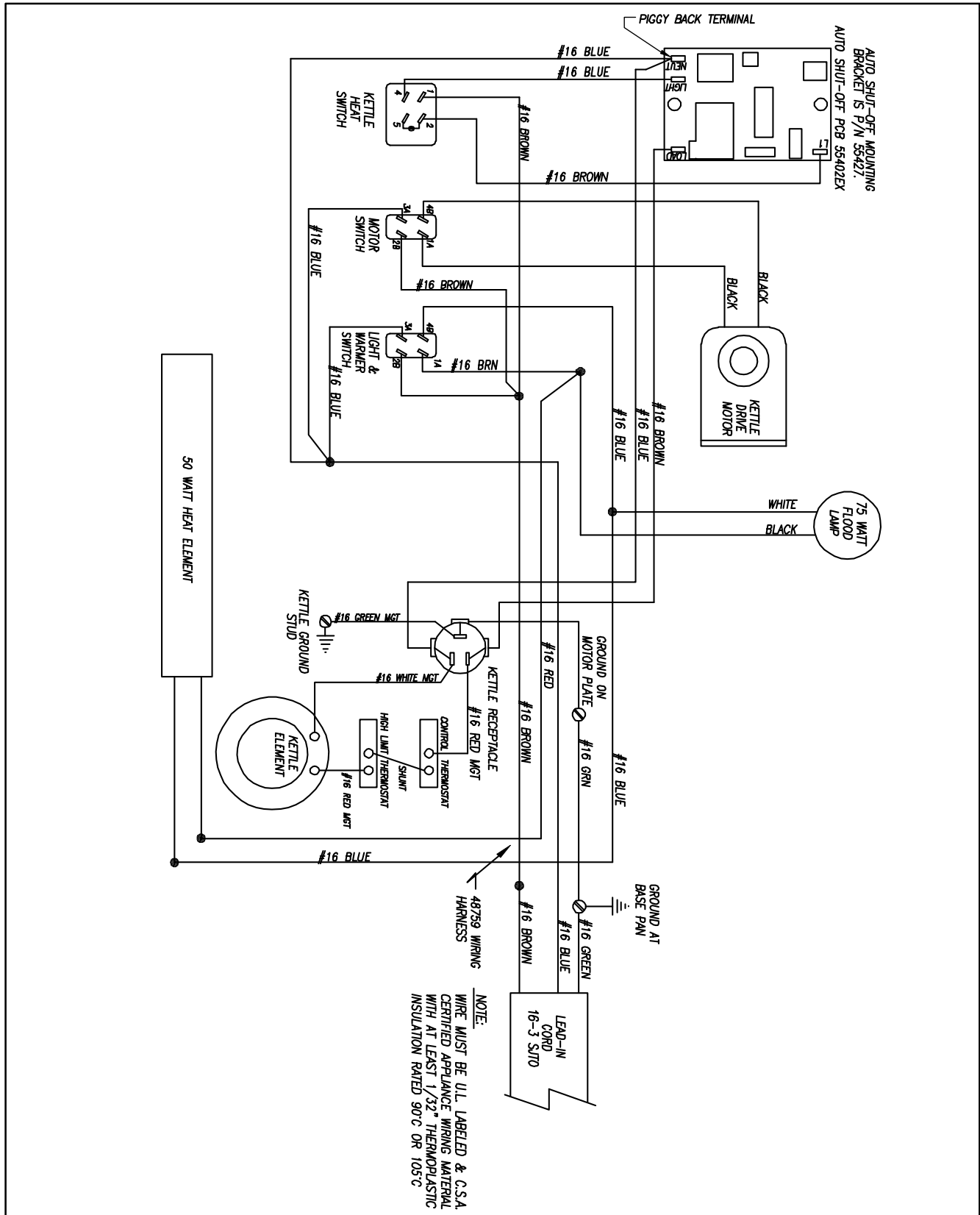



WARRANTY

Gold Medal Products Co. warrants to the original purchaser each item of its manufacture to be free of defects in workmanship and material under normal use and service. Gold Medal Products Co.'s obligation under this warranty is limited solely to repairing or replacing parts, f.o.b. Cincinnati, Ohio, which in its judgment are defective in workmanship or material and which are returned, freight prepaid, to its Cincinnati, Ohio factory or other designated point. Except for "Perishable Parts" on specific machines, the above warranty applies for a period of two (2) years from the date of original sale to the original purchaser of equipment when recommended operating instructions and maintenance procedures have been followed. These are packed with the machine. Parts warranty is two (2) years, labor is six (6) months.

THIS WARRANTY IS IN LIEU OF ALL OTHER WARRANTIES EXPRESSED OR IMPLIED, AND OF ALL OTHER OBLIGATIONS OR LIABILITIES ON OUR PART, INCLUDING THE IMPLIED WARRANTY OF MERCHANTABILITY. THERE ARE NO WARRANTIES WHICH EXTEND BEYOND THE DESCRIPTION ON THE FACE HEREOF. In no event shall Gold Medal Products Co. be liable for special, incidental or consequential damages. No claim under this warranty will be honored if the equipment covered has been misused, neglected, damaged in transit, or has been tampered with or changed in any way. No claim under this warranty shall be honored in the event that components in the unit at the time of the claim were not supplied or approved by Gold Medal Products Co. This warranty is effective only when electrical items have been properly attached to city utility lines only at proper voltages. This warranty is not transferable without the written consent of Gold Medal Products Co.

The term "Original Purchaser" as used in this warranty shall be deemed to mean that person, firm, association, or corporation who was billed by the GOLD MEDAL PRODUCTS CO., or their authorized distributor for the equipment.

THIS WARRANTY HAS NO EFFECT AND IS VOID UNLESS THE ORIGINAL PURCHASER FIRST CALLS GOLD MEDAL PRODUCTS CO. AT 1-800-543-0862 TO DISCUSS WITH OUR SERVICE REPRESENTATIVE THE EQUIPMENT PROBLEM, AND, IF NECESSARY, FOR INSTRUCTIONS CONCERNING THE REPAIR OR REPLACEMENT OF PARTS.

NOTE: This equipment is manufactured and sold for commercial use only.



GOLD MEDAL PRODUCTS CO.

10700 Medallion Drive, Cincinnati, Ohio 45241-4807 USA

gmpopcorn.com

Phone: (800) 543-0862 Fax: (800) 542-1496
(513) 769-7676 (513) 769-8500